

Pillar type fire hydrant
single closing

PN16

FIRE PREVENTION



- **BREAKAGE PROTECTED**
- **MONOLITHIC HEAD WITH OUTLET CONNECTORS**
- **ROTATING HEAD 0° TO 360°**

Product description (standard execution):

- Complete drainage after full cut - off the flow
- Kv factor > 80m³/h - (for 1x65); Kv factor > 140m³/h - (for 2x65); Kv factor > 160m³/h - (for 1x100);
- Dehydration time < 15 min.
- Water-traces < 150 ml (for DN100)
- Stainless steel stem with rolled thread
- O-ring stem sealing, packing cork protected against medium
- Forged packing cork protected against unscrewing
- EPDM fully vulcanized valve plug
- Coat of arms place
- Initial opening < 3 turns; full opening after 8 turns
- MOT 80 Nm
- MST 250 Nm
- Corrosion resistant internal and external parts
- Stand pipe made of ductile cast iron pipe (coated with zinc)
- UV resistant epoxy coating minimum 250 microns according to EN ISO 12944-5
- Resistant against disinfectants (suggested solution NaOCl)
- Flange connection and connector according EN 1092-2 (DIN 2501) pressure PN10; PN16
- Outlet connector B 65 according to DIN 14318
- Outlet connector A 110 according to DIN 14319
- Control key according to 89/M – 74088
- Working pressure PN16
- Product according to EN 1074-1; EN 1074-6; EN 14384 TYPE C
- Product marking according to EN 19; EN 1074

Application:

Potable water lines; fire prevention systems temperature range to +50°C

Test control:

Water pressure test according to EN 1074-1; EN 1074-2; EN 12266-1
 Seat: 1,1 x PN
 Body: 1,5 x PN
 Operation torque test

Accessories:

Hydrant drainage cover - see: 8860

Execution variant:

Self-leveling version
 Tap pipe made of stainless steel 1.4301

Installation:

In vertical position on horizontal pipelines

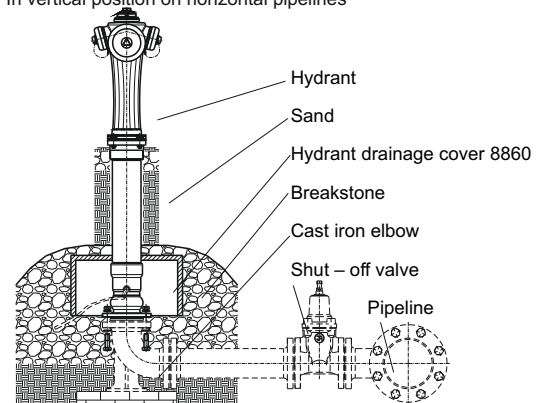

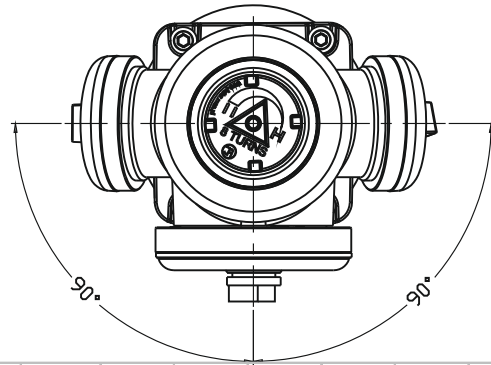
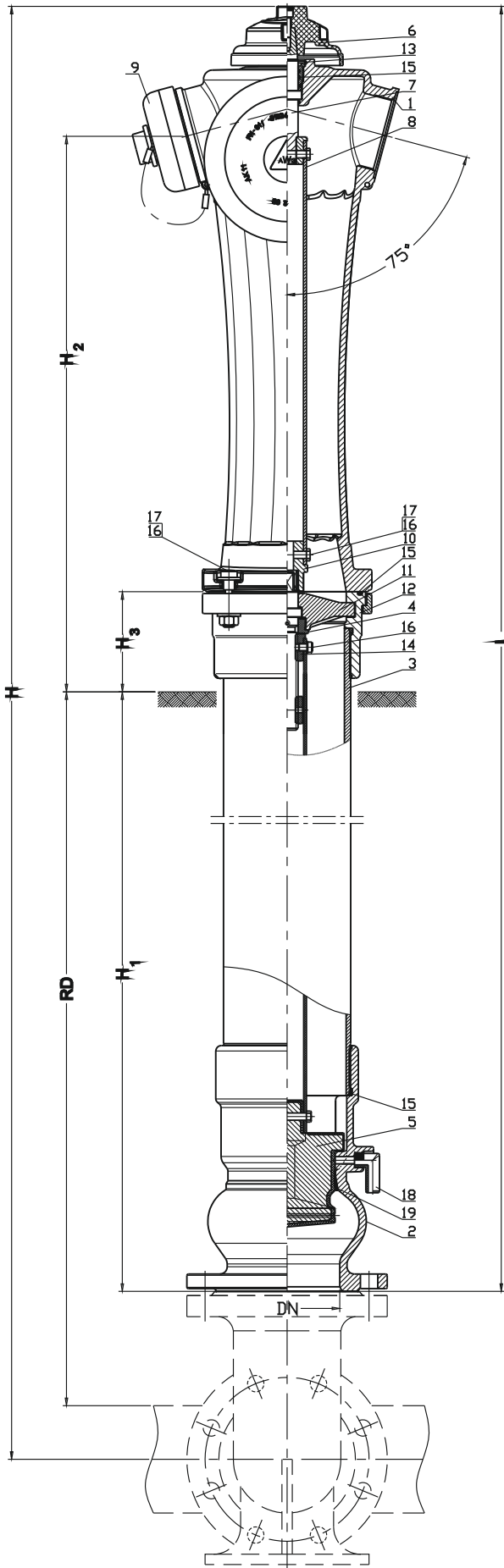

DN	RD	L	H	H ₁	H ₂	H ₃	Weight
[mm]							[kg]
100	1000	1640	1825	875	600	110	57
100	1250	1890	2075	1125	600	110	62
100	1500	2140	2325	1375	600	110	67
100	1800	2440	2625	1675	600	110	73

No.	Part	Standard execution
1	Head	Ductile cast iron EN-GJS-400-15; EN 1563
2	Bottom body	Ductile cast iron EN-GJS-400-15; EN 1563
3	Stand pipe	Ductile cast iron EN-GJS-400-15; EN 1503-3 (Steel 1.0254; Stainless steel 1.4301)
4	Sleeve	Brass CuZn39Pb1Al-B EN 1982
5	Valve plug	Ductile cast iron EN-GJS-400-15; /EPDM; EN 1563 / EN ISO 1629
6	Cap	Aluminium AISi EN 1706
7	Stem	Stainless steel 1.4021 EN 10088-1
8	Spindle	Stainless steel 1.4301 EN 10088-1
9	Outlet connector	Aluminium AISi EN 1706
10	Coupling	Ductile cast iron EN-GJS-400-15; EN 1563
11	Mounted stem	Ductile cast iron EN-GJS-400-15; EN 1563
12	Bottom flange	Ductile cast iron EN-GJS-400-15; EN 1563
13	Gland seal	Brass CuZn39Pb1Al-B EN 1982
14	Stem nut	Brass CuZn39Pb1Al-B EN 1982
15	O - ring gasket	Rubber EPDM EN ISO 1629
16	Screw	Stainless steel A2 EN ISO 4017; EN ISO 4762
17	Nut	Stainless steel A4 EN ISO 4032
18	Dehydrator	Polipropylene PP EN ISO 1873-1
19	Socket	Bronze CuAl7 EN ISO 24373