

Flange adaptor

PN10
PN16

WATER

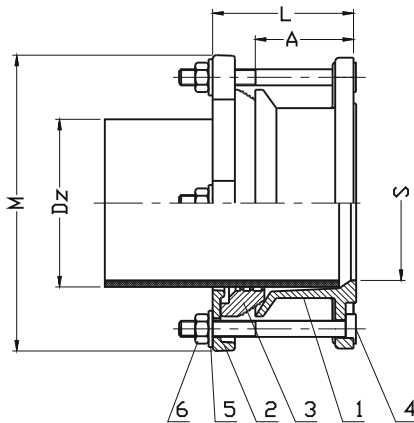

No.	Part	Standard execution
1	Body	Ductile cast iron EN-GJS 500-7
2	Flange	EN 1563
3	Gasket	Rubber EPDM EN ISO 1629
4	Screw	Steel Fe/Zn5 Stainless steel A2 EN ISO 4017
5	Washer	Steel Fe/Zn5 Stainless steel A2 EN ISO 7091
6	Nut	Steel Fe/Zn5 Stainless steel A4 EN ISO 4032

DN*	S	D ₂	L	A	M	Weight
[mm]						[kg]
50	59	57-74	124	75	164	2,7
65	75	63-85	124	75	197	3,5
80	101	84-107	124	75	203	3,7
100	121	106-132	134	75	228	4,4
125	150	132-158	134	75	282	5,6
150	173	157-185	134	75	283	6,0
200	202	189-212	134	75	337	8,3
200	225	218-244	134	75	338	8,3
250	277	264-295	146	85	402	11,4
300	329	315-349	155	100	458	14,8

* DN350 do DN600 on request.

Product description (standard execution):

- Acceptable axial deviation at each end up to $\pm 3^\circ$
- EPDM Rubber sealing approved for potable water
- Stainless steel or galvanized nuts and screws
- Plastic protection caps at screw ends
- Installation in any position allowed
- Body and flange made of ductile cast iron EN-GJS 500-7
- Grooved gasket absorbs minor imperfections of the pipe surface
- Epoxy coating minimum 250 microns according to EN ISO 12944- 5
- Flange connection according to EN 1092-2 (DIN 2501) pressure PN10, PN16

Application:

Water line networks: potable water and other chemically inert fluids. Connection of straight naked-end pipes made of cast iron, asbestos-cement or PVC to fittings flange.
Working pressure up to 1.6 MPa, temperature up to +70°C

Test control:

Water pressure test according to EN 1074-1; EN 12266-1
Seat: 1,1 x PN
Body: 1,5 x PN

We reserve the rights to modify the production program and the given data without separate notices due to the permanent company development